

Core ETD29/16/10

Effective core parameters

$\Sigma l/A$	0,947	mm ⁻¹
l_e	72,0	mm
A_e	76,0	mm ²
A_{min}	71,0	mm ²
V_e	5470	mm ³

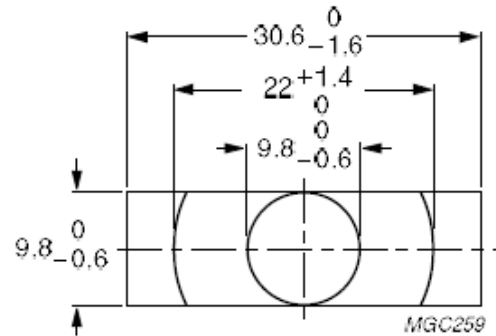
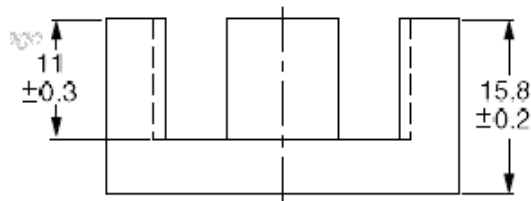

ETD cores are particularly applicable in low power transformers, thanks to the untypical design - flattened center column, placed asymmetrically. Thanks to this we get compact construction and lowered transformer height in comparison to a similar power transformer on the EE core. Below are examples of core materials we use for the manufacture of our products. These cores are with different slots and AL values. The AL values in the table are given for cores without a slot. For our production we also use cores with different slots, ie with different constant AL, eg: 200, 125, as well as others made according to individual customer requirements.

The examples of used materials

Material	AL [nH]
3C90	2350 ±25%
3C94	2350 ±25%
3C95	2860±25%
3C96	2200 ±25%
3F3	2200 ±25%
3F35	1600 ±25%
F-867	2300±25%
F-887	2250 ±25%
N27	2000+30/-20%
N87	2200 +30/-20%
N97	2250 +30/-20%