

Core RM12/ILP

Effective core parameters

$\Sigma l/A$	0,280	mm ⁻¹
I_e	42,0	mm
A_e	148	mm ²
A_{min}	125	mm ²
V_e	6200	mm ³

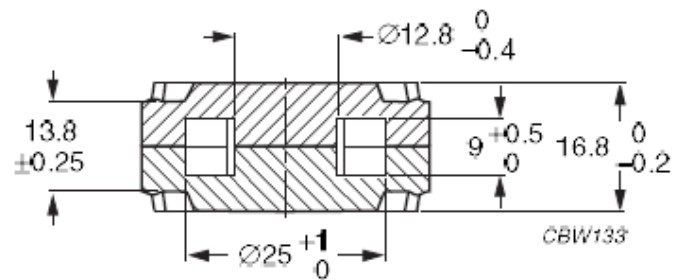
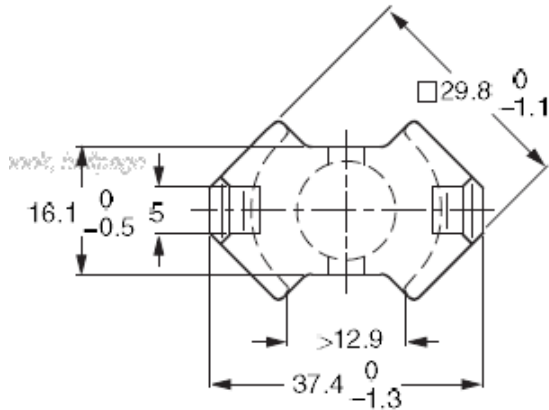

RM cores are mainly used in Telecommunication and pulsed transformers, where galvanic separation is required, as well as in chokes and coils and resonant circuits. The shape of the cores enables optimal use of the winding space with very good magnetic shielding. Below are examples of core materials we use for the manufacture of our products. These cores occur with different slots and AL values. AL values are given for cores without slots.

The examples of used materials

Material	AL [nH]
3C90	7100 ±25%
3C94	7100 ±25%
3C95	8470 ±25%
3C96	6700 ±25%
3F3	6700 ±25%
3F35	5000 ±25%
3F4	3600 ±25%
N49	4500 +30/-20%
N92	4800 +30/-20%
N87	6300 +30/-20%