

Core RM12/I

Effective core parameters

$\Sigma I/A$	0,388	mm ⁻¹
I_e	56,6	mm
A_e	146	mm ²
A_{min}	125	mm ²
V_e	8340	mm ³

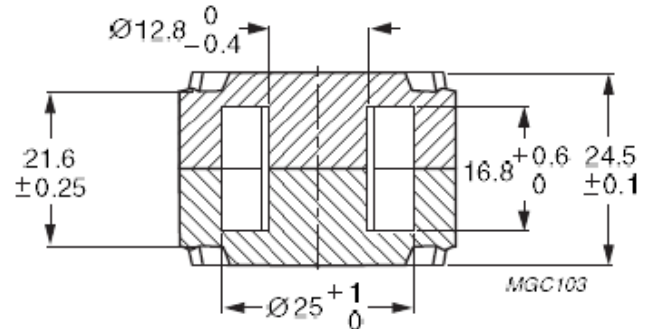
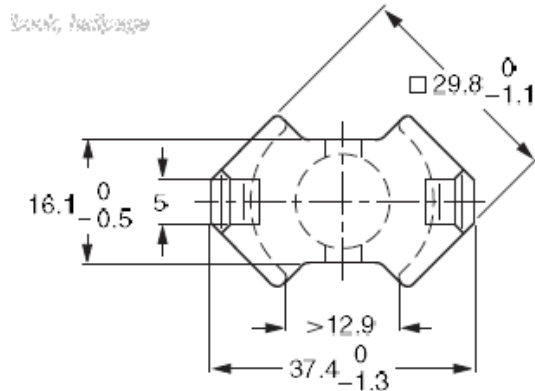

RM cores are mainly used in Telecommunication and pulsed transformers, where galvanic separation is required, as well as in chokes and coils and resonant circuits. The shape of the cores enables optimal use of the winding space with very good magnetic shielding. Below are examples of core materials we use for the manufacture of our products. These cores occur with different slots and AL values.

AL values are given for cores without slots. For our production we also use cores with different slots of different constant AL such as: 630, 400, 315, 250, 160 and other made according to individual customer requirements.

The examples of used materials

Material	AL [nH]
3C90	5600 ±25%
3C94	5600 ±25%
3C95	6790 ±25%
3C96	5050 ±25%
3F3	5050 ±25%
N30	7600 +30/-20%
T38	16000 +40/-30%
N49	2900 +30/-20%
N87	4200 +30/-20%
N97	4200 +30/-20%
N41	5500 +30/-20%
F-867	5200 ±25%
F-887	5000 ±25%