

Core RM4/I

Effective core parameters

$\Sigma I/A$	1,69	mm ⁻¹
I_e	23,3	mm
A_e	13,8	mm ²
A_{min}	11,50	mm ²
V_e	322,0	mm ³

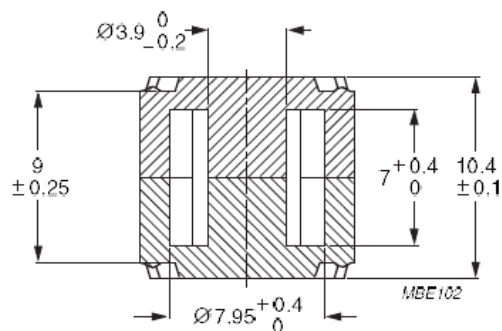
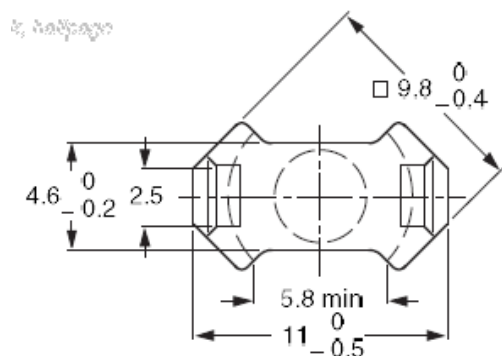

RM cores are mainly used in Telecommunication and pulsed transformers, where galvanic separation is required, as well as in chokes and coils and resonant circuits. The shape of the cores enables optimal use of the winding space with very good magnetic shielding. Below are examples of core materials we use for the manufacture of our products. These cores occur with different slots and AL values. AL values are given for cores without slots. For our production we also use cores with different slots of different constant AL such as: 250, 160, 100 and other made according to individual customer requirements.

The examples of used materials

Material	AL [nH]
3C90	1125 ±25%
3C94	1125 ±25%
3C95	1320 ±25%
3C96	1000 ±25%
3F3	950 ±25%
3F35	800 ±25%
3F4	560 ±25%
3F45	560 ±25%
N45	1700 +30/-20%
N30	1900 +30/-20%
T35	2800 +40/-30%
T38	3700 +40/-30%
N49	750 +30/-20%

N87	1100 +30/-20%
N97	1100 +30/-20%